



Forward Thinking, High Achieving.

COLD SPRINGS ELEMENTARY SCHOOL

Our proposal addresses areas of critical need, including up-to-date security, ADA compliance, parent access, 21st century technology needs, and space that fosters collaborative learning.



A systemwide initiative to develop schools that work smarter for our students.

MEET YOUR SMART SCHOOLS TEAM

The Cold Springs Elementary School team put months into this process. We appreciate the input from students, parents, faculty, neighbors and the MCPS board. If you have questions or would like to get involved, we encourage you to visit www.mcpsmt.org/coldsprings or contact Principal Jill Sheridan at jrsheridan@mcps.k12.mt.us.

TEAM MEMBER CORE

Jayden Salisbury, Student
Michelle Salisbury, Teacher/Parent
Teresa Thane, Staff Member
Webb Harrington, Administrator
Julene Shea, Parent
Eric Petersen, Business/Community

TEAM MEMBER EXPANDED

Vinny Giammona, Teacher
Robyn Babcock, Staff Member
Bryan Peterson, Business/Community
Dawn Lense, Staff Member
Stacy Lindsay, Parent
Parker Lindsay, Student
Chris Nowlen, Business/Community
Tijon Morin, Parent
Jerry Contonio, Business/Community
William Maloney, Parent

21ST CENTURY NEEDS

Cold Springs Elementary School, originally built in 1930, presently serves approximately 500 K-5 students. While a wonderful historical site, the building has received many unconventional additions. Today, overcrowding, inadequate technology infrastructure and an aged building create educational and safety and security deficits that do not support 21st century teaching and learning.

EXPANDING COLD SPRINGS ELEMENTARY SCHOOL

Our proposed option relocates and rebuilds Cold Springs in a new facility constructed near Marilyn Park, Meriwether, Linda Vista or Lower Miller Creek. The revitalized facility will provide needed improvements in school safety and security, flexible spaces for increased classroom collaboration, and up-to-date technology meeting the needs of our 21st century learners. When complete, Cold Springs will be a smarter school in many ways, including:

- An obvious main entry, secure waiting area, with the ability to observe visitors approaching the building.
- The building subdivided into secure zones with electronically activated door closers.
- Adequate parking and safe parent drop-off/pickup zones as well as an appropriate bus loop.
- An infrastructure that supports robust technology use that is educational and impactful.
- Flexible learning spaces throughout that accommodate a variety of uses, including the traditional classroom, smaller collaborative groups and 1:1 tutoring, as well as areas for teacher collaboration, centers and storage.
- ADA compliance throughout, ensuring equal access to the entire facility.

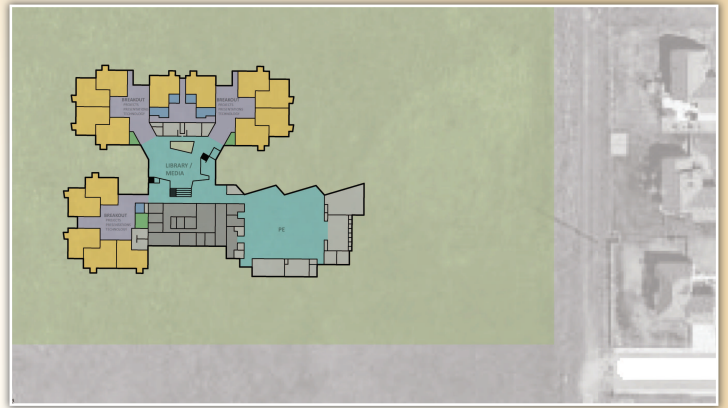

OUR TEAM'S RECOMMENDED OPTION

OPTION R-1 REALIGN, RELOCATE, RENOVATE:

- Finalize site location selection.
- Construct a new Cold Springs Elementary School.

SECURITY

Modify facility to create obvious main entry, secure waiting area and ability to observe visitors approaching the building. Subdivide the building into secure zones with electronically activated door closers.

TECHNOLOGY

Develop high-speed/high-volume fiber optic distribution to breakout spaces for projects, presentations and technology in each learning community, enhanced with robust wireless and hard-wired access points.

ENVIRONMENT

Install barn doors and garage doors with quality acoustical materials between learning areas and breakout areas for projects, presentations and technology. Create small learning communities for teams of teachers and students that include traditional classrooms as well as important support spaces for 1:1 tutoring, small groups, planning centers, storage, etc.



FACILITIES STRATEGIC PLAN

Site Area: 6.76 acres
Parking Spaces: 65
Building Square Footage
Existing: 51,382
Estimated Project Budget: \$11,115,221*
Rental / Lease / Sale Income: None
Current Enrollment: 495
Future Peak Enrollment: 477
Capacity: 450-500
Accessible Capacity: 450-500
Accessible / Permanent Capacity: 450-500

*All costs are projected based on industry averages for building costs, sizes and land prices. Final project budget will be developed during the design phase.



NOW IS THE TIME TO INVEST IN SMARTER SCHOOLS

Education has never been more important than it is today. Our students face international competition for scholarships and jobs, and an increasing pace of change that impacts their futures. Yet, while the need for quality education continues to increase, our schools are physically in decline.

At Missoula County Public Schools, we realize that we must change if we're to keep up academically and economically as a community. That's why we launched Smart Schools 2020. Led by teams from each school, the initiative assesses needs by facility and prioritizes those needs in light of achieving our goals of a 21st Century Educational Culture and of being fiscally responsible.

By addressing schools now we prevent further deterioration of facilities, better prepare for population growth and ensure our students continue to get the educational opportunities they need to succeed in school and beyond.

THE SMART SCHOOLS PROCESS

SCHOOL CENTRIC:

Criteria and preferred options were established for each school by a team of teachers, administrators, students and parents from that school, along with members of the Missoula community.

COLLABORATIVE:

Alternatives were shared at public meetings at each school. In addition, surveys were sent out systemwide to vet priorities.

REALISTIC:

Team recommendations were reviewed by the steering committee and the elected board of trustees before a bond measure was drafted.

PUBLIC:

Everyone is invited to review options and weigh in. Final support for the initiative will be determined by public election in November 2015.



To get involved, please visit www.mcpsmt.org/coldsprings or contact Principal Jill Sheridan at jrsheridan@mcps.k12.mt.us.